

## Aliise Moora auditorium

A neutral room with 2 big glass windows is situated in the building's A-area. The room can be used as a seminar hall as well as an active learning hall. Furniture: touch-screen interactive board- TV I, 65" lector's table with wheels

- Area: 73m<sup>2</sup>
- Daylight: Yes
- Capacity: 30 people seated cafe-style, 50 people seated theater-style



## Helmi Kurriku auditorium

A neutral room with 2 big glass windows is situated in the building's A-area. The room can be used as a seminar hall as well as an active learning hall. Furniture: touch-screen interactive board- TV I on the wall, 65" lector's table, 10 study tables, chairs

- Area: 62 m<sup>2</sup>
- Daylight: Yes
- Capacity: 30 people seated cafe-style, 50 people seated theatre-style



## Ilmar Mannineni videoauditorium

An excellent video conference hall with many technical possibilities is situated on the left hand of the building's A-area. Furniture: conference/training presentation system „Vision Presenter“- multi-screened presentation system to carry through conferences and seminars, 5x FullHD video simultaneous presenting, pre-configurative screen arrangement, min 5 simultaneous opened windows on the screen. 2 lazer projections Sony VPL FHZ57 4100 lm, 3LCD Picture element, edge-blending function for integrating multiple projections into one wide picture, simultaneous presentation on the screen of 2 inputs, screen of the projection on the coloured wall (white), sound system PANARAY 302A, FreeSpace® ZA 2120-Hz Zone Amplifier- receiver, mixer Soundcraft EFX12

- Area: 85m<sup>2</sup>
- Daylight: No
- Capacity: 45 people seated theatre-style



## The hall of Jakob Hurt

A conference hall seating up to 250 people is located in the building's A-area. It's equipped with modern sound-, light- and presentation equipment. Technical support is guaranteed during the rental period. The hall is connected to 4 simultaneous translation cabins (without technical support). Excellent access for disabled people from the cloakroom level. First three rows are mobilized, standard-seating with extra wide legroom. The hall's back wall is covered with an art piece called „Strobile and Stumps“, specially designed and created carpet for Estonian National Museum that pictures 10 stems of widely- spread trees in Estonia with common last names linked to trees.

- Area: 250 m<sup>2</sup>
- Daylight: No
- Capacity: 250 people seated theatre-style



## Worldmovie cinema hall

Located on the second floor of the left-side of the building's A-area, there is a cinema hall named after a documentary festival taking place in Estonian National Museum. The room is built into cinema hall. Furniture: Full HD home cinema projection VPL-HW65ES, 3D preparedness, Surround sound system (cinema sound 7.1) – Bose Acoustimass® 10 V + 2 additional speakers, screen 135", opaque white textile stretched to the frame, the size of the Picture 3 x 1,68m + the frame.

- Area: 70 m<sup>2</sup>
- Daylight: No
- Capacity: 35 people seated in theatre-style



## Matthias Johann Eisen auditorium

The auditorium is situated on the left hand of the building's A-area. It has two large glass walls offering spectacular views on Lake Raadi. The room is closely located to conference hall. Chairs and tables can be arranged according to the need. Furniture: touch-screen interactive board-TV 65" on the wheels.

- Area: 46 m<sup>2</sup>
- Daylight: Yes
- Capacity: 25 people seated cafe-style, 25 people seated theatre-style



## Oskar Kallas auditorium

A distinctively designed bright hall with spectacular views is located on the right hand of the building's A-area. Its high ceiling (9 m) is visually brought lower with suitable lightning. Furniture: touch screen interactive board- TV I on 65" wheels.

- Area: 40 m<sup>2</sup>
- Daylight: Yes
- Capacity: 25 people seated cafe-style, 30 people seated theatre-style



## Theatre hall

A multiple-use black box hall (13 m x 16m) is situated in the B-area of the building. The hall is equipped with an up-to-date sound, light and presentation system. All technical systems are easily accessible. We also provide technical support with the service. Podiums (standard and corner) and chairs (seating up to 220 people in theatre-style) can be arranged according to the need.

- Area: 208 m<sup>2</sup>
- Daylight: No
- Capacity: 120 people cafe-style, 220 people seated theatre-style (with elevation)





## Bridge-area reception area

- Area: 580 m<sup>2</sup>
- Daylight: Yes
- Capacity: 500 people seated theatre-style, 1000 people standing



### A- area full capacity

- Area: restaurant 445 m<sup>2</sup>, public space 897 m<sup>2</sup>, lobby 580 m<sup>2</sup>
- Daylight: Yes
- Capacity: 1000+ people standing
- Special accommodation: big receptions, stage, lightning, projections etc.

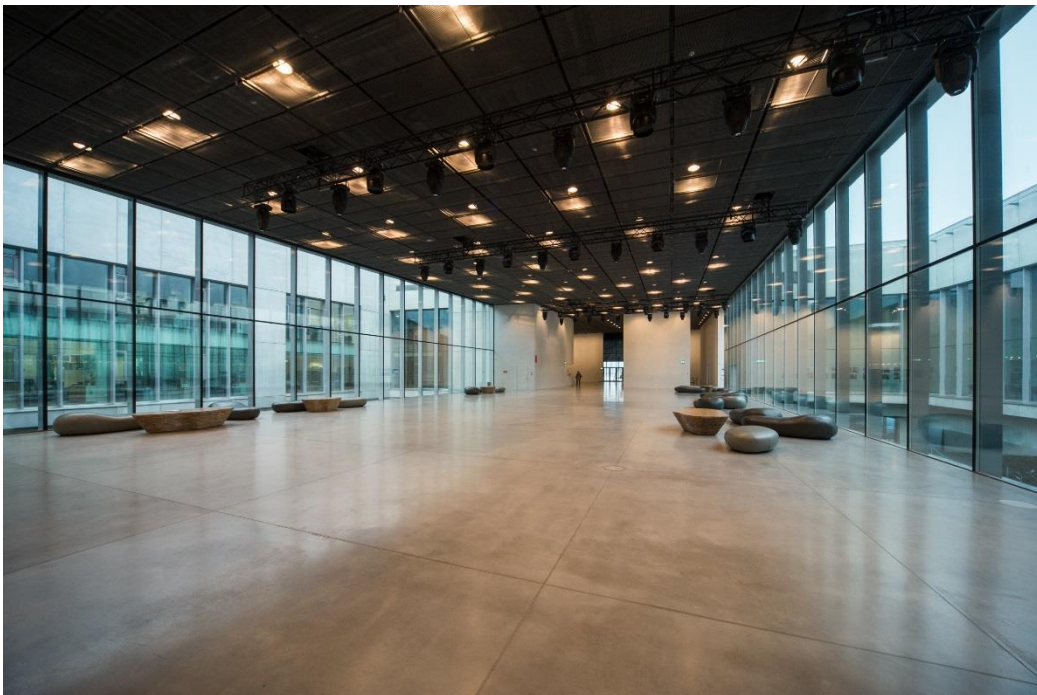

### B-area full capacity

- Area: cafe 323 m<sup>2</sup>, theatre hall 208 m<sup>2</sup>
- Daylight: Yes
- Capacity: 500 people seated theatre-style, 500 people standing
- Special accommodation: two-level, 200 people in cafe, 250 people in the theatre hall